

HÖHEN BELADEN

VORBIEGUNG: 6490/26

ACHTUNG: FAHRZEUG UNTERLIEGT
EXTREMER DURCHBIEGUNG BEI
BELADUNG.

| | | | |
|---|----------|---|-----------|
| <small>ALL RIGHTS RESERVED REPRODUCTION OR DISCLOSURE TO THIRD PARTIES OF THIS DOCUMENT OR ANY PART THEREOF IS NOT PERMITTED, EXCEPT WITH THE PRIOR AND EXPRESS WRITTEN PERMISSION OF ROYAL NOOTEBOOM TRAILERS B.V. WIJCHEN, HOLLAND.</small> | | TOLERANTIE Wanneer geen tolerantie aangegeven geldt ± 1mm | |
| DATUM | 20/10/14 | EURO-47-02 (P) C013940(02), TKS Rostock GmbH & Co. KG | |
| GET. | FUIT | | |
| GEC. | | | |
| | | OPMERKING | PROJEKTIE |
| | | ACUUT VAN | |
| WIJCHEN HOLLAND | | TEK.LIJST | FORMAAT |
| | | SCHAAL | A3 |
| | | 1:75 | TEK.NR: |
| | | | 5304393 |
| WIJZIGING | | PAR. | DATUM |
| | | | WIJZ.LTR |

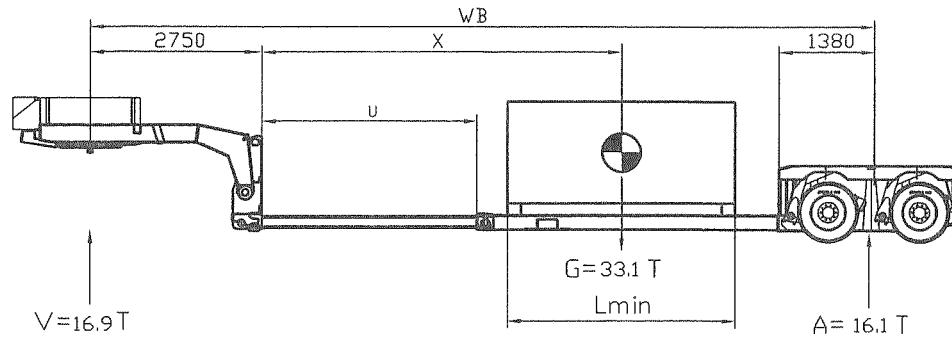

| Schiebestufen U [mm] | Ladefläche Länge LL [mm] | Wb [mm] | Schwerpunktslage X [mm] | Stützabstand Lmin [mm] |
|----------------------|--------------------------|---------|-------------------------|------------------------|
| 0 X 500 | 6470 | 10600 | 2420 | 100 |
| 1 X 500 | 6970 | 11100 | 2670 | 2970 |
| 2 X 500 | 7470 | 11600 | 2910 | 3470 |
| 3 X 500 | 7970 | 12100 | 3150 | 3970 |
| 4 X 500 | 8470 | 12600 | 3400 | 4470 |
| 5 X 500 | 8970 | 13100 | 3640 | 4970 |
| 6 X 500 | 9470 | 13600 | 3890 | 5470 |
| 7 X 500 | 9970 | 14100 | 4130 | 5970 |
| 8 X 590 | 10560 | 14690 | 4420 | 6560 |

80 KM/H

$$\begin{aligned} \text{Katrak} &= 23 \text{ T} \\ \text{e.g.} &= 6.1 \text{ T} \\ \hline V &= 16.9 \text{ T} \end{aligned}$$

$$\begin{aligned} \text{Asl. } 2 \times 12 &= 24 \text{ T} \\ \text{e.g.} &= 7.9 \text{ T} \\ \hline A &= 16.1 \text{ T} \end{aligned}$$

$$G = V + A$$

$$LL \rightarrow L_{min} = LL - 4000$$

$$X = \frac{A \times Wb}{G} - 2750$$

| | | | |
|---|----------|---|---------------------|
| ALL RIGHTS RESERVED REPRODUCTION OR DISCLOSURE TO THIRD PARTIES OF THIS DOCUMENT OR ANY PART THEREOF IS NOT PERMITTED, EXCEPT WITH THE PRIOR AND EXPRESS WRITTEN PERMISSION OF ROYAL HOOITEBOOM TRAILERS B.V. WIJCHEN, HOLLAND. | | TOLERANTIE Wanneer geen tolerantie aangegeven geldt ± 1mm | |
| DATUM | 16/01/15 | BELADINGSADVIES EURO EURO-47-02(P), 80KM/H | PROJEKTIE |
| GET. | MJON | | |
| GEC. | | | FORMAAT |
| | | | ACUUT VAN |
| | | OPMERKING | TEK.LIJST |
| | | WIJCHEN HOLLAND | SCHAAL |
| | | | 1:75 |
| | | | TEK.NR: 5325079 |
| | | WIJZIGING | PAR. DATUM WIJZ.LTR |